



# COWL BEZEL INSTALLATION V8/V6 OUTBOARD

**IMPORTANT:** This document guides our dealers, boatbuilders, and company service personnel in the proper installation or service of our products. If you do not feel confident in the recommended servicing or installation procedures for these or similar Mercury Marine products, have the work performed by an authorized Mercury Marine dealer technician. Improper installation or servicing of the Mercury product could result in damage to the product or personal injury to those installing or operating the product. Always refer to the appropriate Mercury Marine service manual for component removal and installation instructions.

**NOTE:** After completing installation, place these instructions with the product for the owner's future use.

## Components Contained in Kit

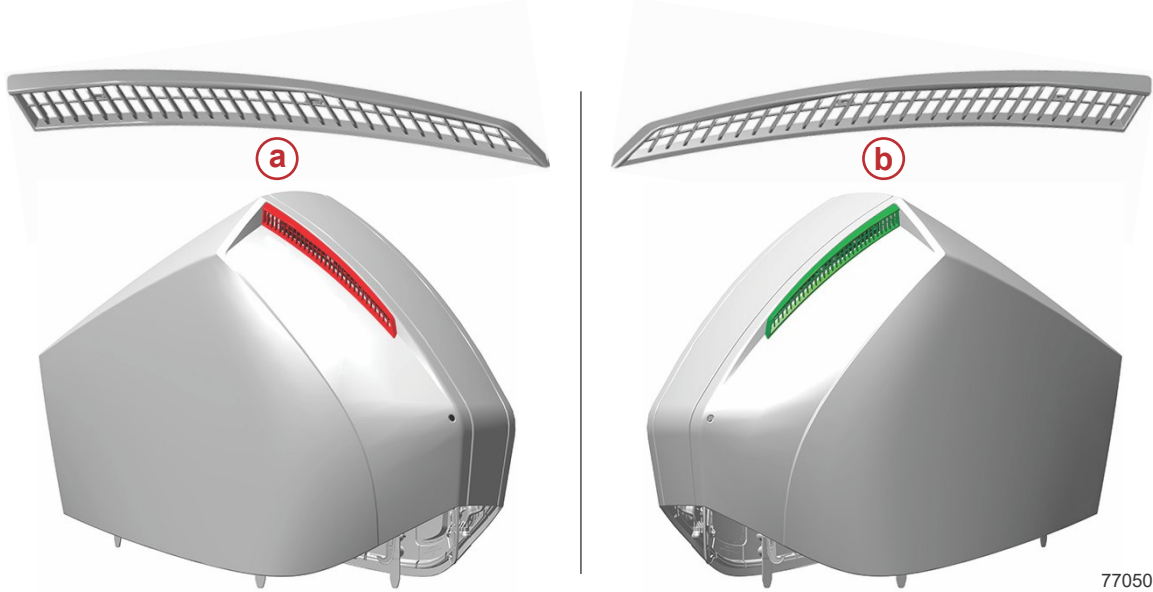

Ref.	Qty.	Description
a	1	Left bezel
b	1	Right bezel

## V8/V6 FourStroke Cowl Bezel Installation

Scan the QR code, following, to view the V8/V6 FourStroke Cowl Bezel Installation video. Or, visit <https://www.youtube.com/watch?v=2GXvCiJ6jiw>.



**IMPORTANT:** During fit up and initial positioning, ensure that the VHB® Tape backer remains intact. VHB is a permanent adhesive, and repositioning or removing the bezel once the VHB makes contact will hinder the adhesion longevity and could destroy the part.

### **⚠ WARNING**

Some cleaners and solvents are flammable. Improper use can result in serious injury or death from fire or explosion. Do not use flammable cleaners on energized equipment, use in a well-ventilated area, and keep away from open flames or sources of ignition.

1. Ensure that the cowl is at approximately room temperature, 21 °C (70 °F).

**NOTE:** The top cowl must be at room temperature for the bezel to adhere properly to the cowl. The installer may need to warm the cowl with a hair dryer or a heat gun. The bezel will properly cure to the cowl in approximately two hours if it is left at room temperature. Failure to allow the cowl to cure may cause the bezel to lift from the cowl.

2. Clean both sides of the cowl with a 50/50 mixture of isopropyl alcohol and water. Allow the mixture to air dry before installing the bezel.

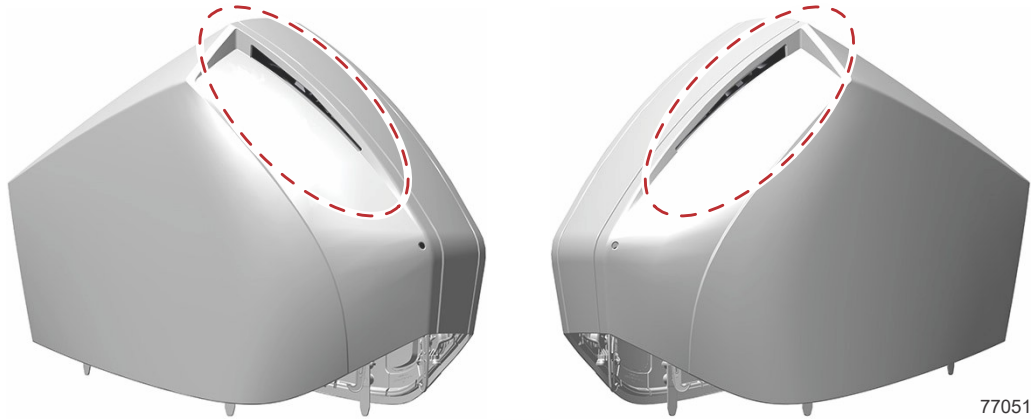

**Clean these areas**

3. Completely remove the top tape backing and fold over the end of the lower tape backing on the bezel.

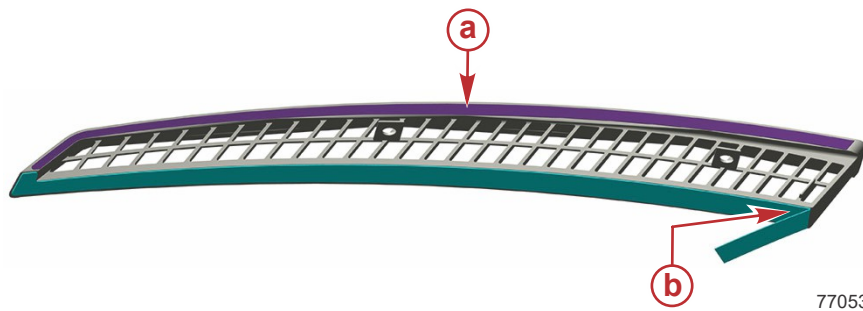

**Left bezel, back, tape side shown**

- a** - Remove top tape backing
- b** - Fold lower backing at an angle

4. Place the bezel on the cowl nested in the corner as shown.
  - a. Seat the bezel against the front wall, ensuring that the lower tape tab remains accessible.
  - b. Ensure that there are no gaps in the corner and gently seat the upper tape to the cowl.

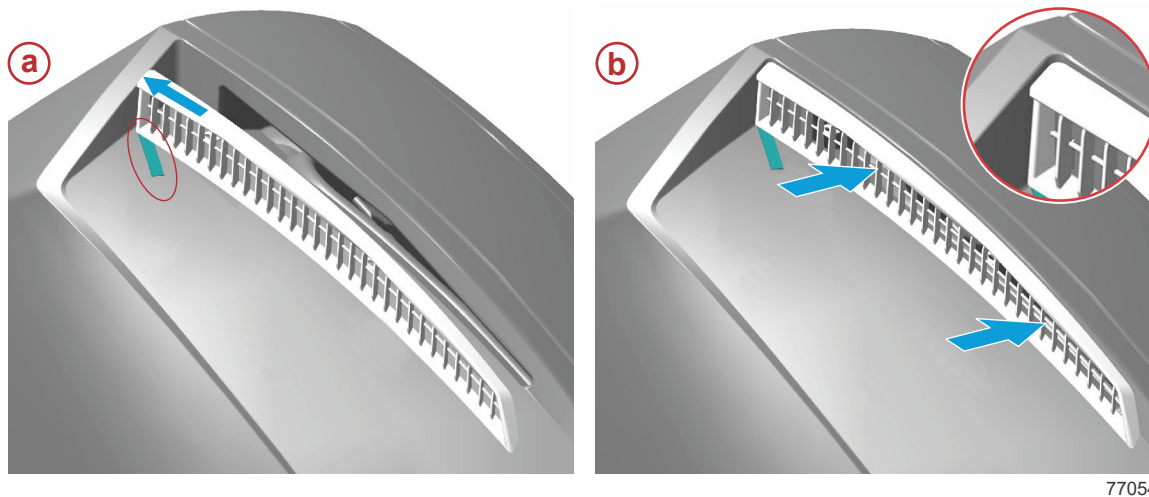

**Left bezel shown**

- a** - Seat bezel against front wall, keeping tape tab accessible
- b** - Ensure no gaps and seat the upper tape to cowl

5. Pull the lower tape backer until it is completely removed, then press firmly on the entire bezel to secure it to the cowl.

**NOTE:** Once the VHB backer is completely removed, press firmly on the area where the VHB tape resides. Apply hand pressure to the bezel for approximately 15 seconds.

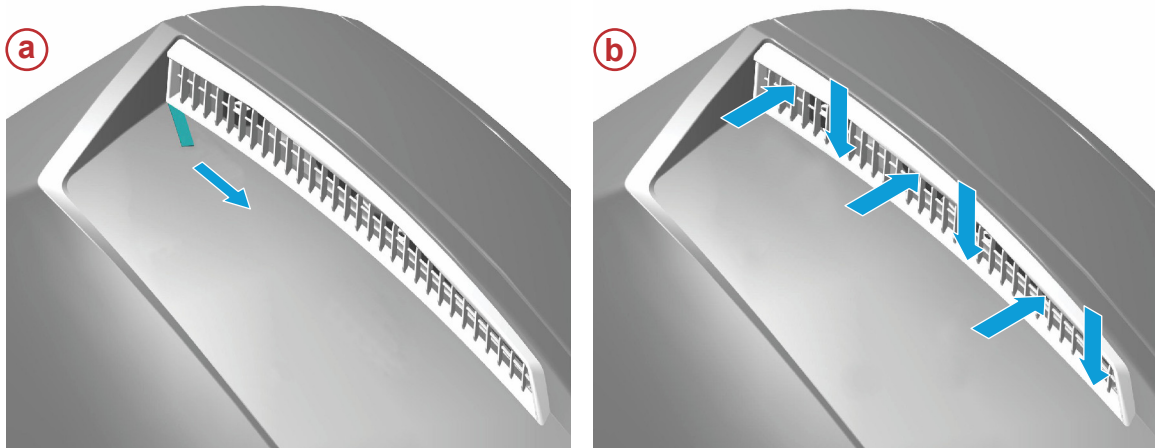

77055

**Left bezel shown**

- a** - Pull lower tape backer to remove
- b** - Press firmly on bezel

6. Repeat the steps for the right side.
7. Allow the cowl to cure for two hours at room temperature. Failure to allow curing may cause the bezel to lift from the cowl.

## V8/V6 FourStroke Cowl Bezel Removal

In the event that bezels are damaged or installed incorrectly, use one of the following options to remove the bezels. Do not reinstall bezels once they have been removed.

### Option A: Fishing Line

Pulling a fishing line between the bezel and the cowl can be an effective method to break the tape bond.



77525

1. Start the fishing line on the outside corner between the cowl and bezel.
2. To avoid paint damage, align the fishing line parallel to the cowl surfaces and pull the fishing line back and forth to cut the tape between the parts.
3. Once the fishing line reaches the lower tab, the fishing line will no longer pull further up the bezel.
4. Pry the bezel away from the cowl by hand, until it completely detaches. Then remove the remaining tape with a citrus based cleaner.

### Option B: Plastic Pry Bar

A plastic pry bar can be used to separate the bezel from the cowl.

**IMPORTANT:** Do not use metal tools like screwdrivers or metal pry bars to separate the bezel from the cowl. These types of tools will cause damage to the cowl.



77526

1. Push a plastic pry bar between the cowl and top of the bezel, cutting into the tape.
2. Create a gap large enough to use fingers to pull the bezel away from the cowl. Be careful not to damage the paint.
3. Continue to work down the bezel until it completely detaches. Then remove the remaining tape with a citrus based cleaner.

Before attempting to install new bezels, ensure that all tape residue is completely cleaned from the cowl. Then follow the **V8/V6 FourStroke Cowl Bezel Installation** instructions.